

THURSDAY POOLS®

Your weekend starts early with us

Goliath 1225

Depth: 3'-8" to 5'-4"

Dig sheets are provided only as a reference for excavation and they may be updated from time to time.
It is installers responsibility to ensure they are utilizing the most current dig sheet version at each installation.

Typical Overdig
approx 1'
If using FPA
(Fiberglass Pool
Anchor System)
20" to 24"

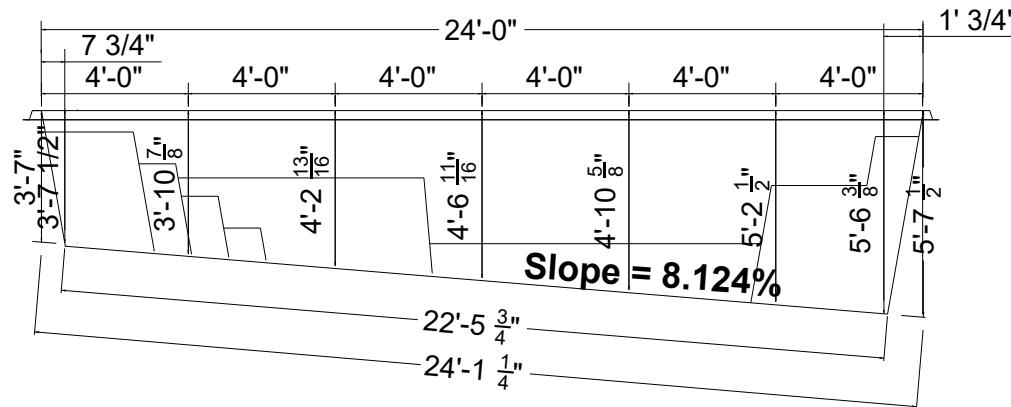
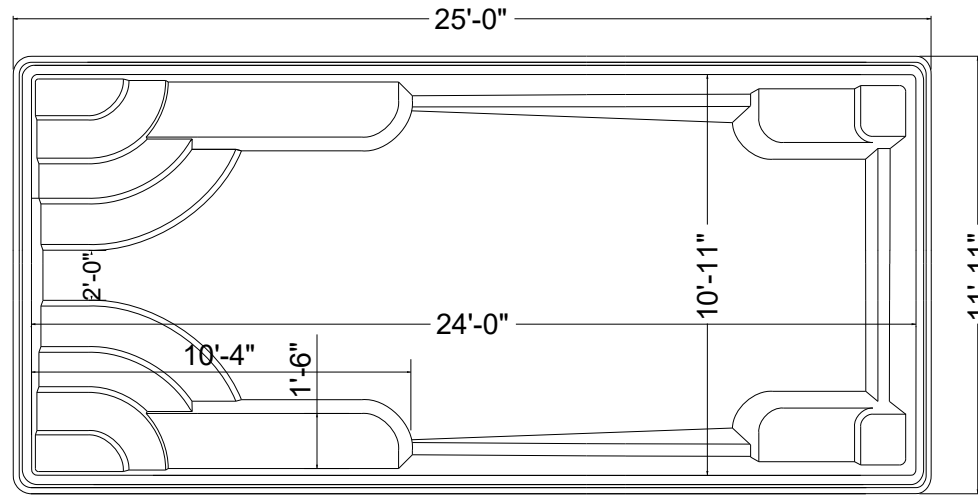

(Add approx 1/4" for fiberglass floor thickness)

PLEASE SEE RECOMMENDED INSTALL
PRACTICES AND FULL INSTALLATION MANUAL

NON DIVING POOL

THURSDAY POOLS, LLC
your weekend starts early with us . . .
840 Commerce Parkway
Fortville, Indiana 46040
Note: for technical help please call Thursday Pools LLC at
Toll Free (877) 929-POOL (7665)
Local (317) 973-0200

POOL NAME: **Goliath 1225**
OWNER:
ADDRESS:
POOL DEALER:

To be filled out by
Thursday Pools, LLC
Date: 8/27/24
Job No.
File No.
Sheet No.
D8
Revision No. 02

SPECIFICATIONS:
Volume: ~8,500 gal
Weight: ~1,820 lbs
Perimeter: 70' (est)
SCALE:

CONTROL

Designed By: TP
Confirmed Pattern: DC
Confirmed in Field:

*All depths reflect the depth of the pool structure.
Water depths may vary depending on the amount of water in the pool.

This NOTICE AND DISCLAIMER is made to all retail customers, buyers, and end users of pools manufactured by Thursday Pools.
You are by this NOTICE advised that pools manufactured by Thursday Pools (the "MANUFACTURER") are sold by independent dealers and dealerships.
Each dealer is an independent businessperson who is completely separate from the MANUFACTURER. Each dealer is an independent contractor,
and no dealer is an owner, agent (in fact or law), or employee of the MANUFACTURER. The MANUFACTURER hereby DISCLAIMS any liability
for an intentional or negligent act by any dealer, dealership, or installer, or any damage to any Thursday Pools pool caused by an act of any dealer, dealership, or installer.

General Tolerance +/- 1/2"